

Project

VIADUC NURSERY AND CAFETERIA

chaussée de Waterloo 1253
1180 Bruxelles

Architects

B612 ASSOCIATES

Tél : 32 2 732 96 93
Fax : 32 2 735 05 92

Address

rue du Viaduc , 1050 Bruxelles (Ixelles)

Programme

The project realized in the framework of the contract of the Blyckaerts district in Ixelles covers a partially listed patrimonial building. The programme envisions the heavy renovation of the building and the transformation of parts of its premises for the creation of a day care centre and a cafeteria. It was also a matter of taking advantage of the opportunity for intervention to create a stronger relationship between the public and semi-public spaces of the park and the former building.

limei.tsien@b612.be
<http://architecte.b612associates.net>

OTHER PROJECTS :

Dolez - Housing units
- 2005 2010
- Uccle

Aime-Dupont Nursery and Health Center
- 2016 2020
- Etterbeek

Charmille-Schuman
- 2011 2020
- Bruxelles

Bruyn - Nursery and Eco-housing
- 2008 2012
- Bruxelles

About

The first intervention in the project is on the surrounding wall in a manner that would create a visual interaction towards the building and the park, by replacing the bare partitions with a laser-cut stainless steel panels following the motif of historical geographic maps.

This motif is reused on the elevation of the day care and the cafeteria in order to, on one hand, demonstrate the renewal of this neighbourhood's cultural centre, and on the other, through the symbolic value of the motif, to relate the new interventions to the history of the neighbourhood and the building.

The metallic laser cut screens offer various states of transparency depending on the percentage of laser cut voids, which represent the densification of the neighbourhood buildings in time. Depending on the proportion of the voids, different panels are used to accommodate the various needs of the building, such as letting in or restricting levels of light or creating views.

The metal skin wraps around the building and creates the terrace and the canopy, then it extends into the interior to the cafeteria, where it constitutes the furniture. The continuity extends furthermore towards the floor to dress the elevation of the nursery and it terminates in the form of a sunshade for those bays facing South.

The concept for the organisation of the space in the day care is primarily orientated to the wellbeing of the children: the space there is rendered warm by the utilization of timber, the natural

Typology

Education

Status

Built

Conception

2005

Delivery

2009

Client

Commune d'Ixelles



Â© B612 associates



Â© B612 associates

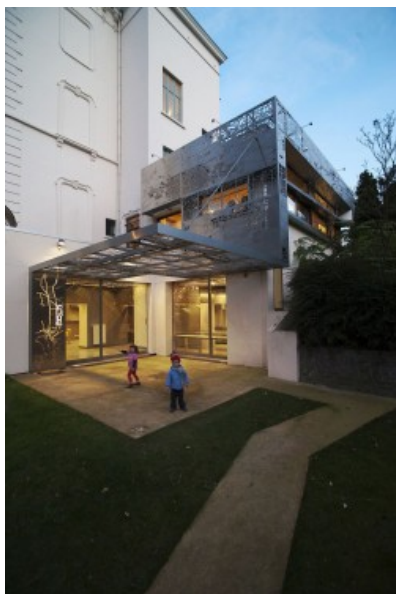

Â© B612 associates



Â© B612 associates



Â© B612 associates