

Project

OFFICE - ANTHE

Architects

LUC SPITS

Address

Rue de la Câblerie, 5, 4000 Liège

Programme

For the headquarters of this company specialized in recruitment and support for the high-tech industry, the challenge was to score through innovation.

In a compact space, the building contains offices, meeting rooms and versatile spaces with all the inherent equipments.

About

Inspired by the antique cloister, this new modern building accommodates an office activity in a quiet square in the heart of the city.

Setback from the road, behind vegetable screens, the volume carved with sharp edges takes its place with humility. With an alliance between concrete and steel, the project is frank but above all very rational, a quality that is extended in the interior fittings.

Once parked under the building, the visitor takes a central staircase leading to the heart of the building. A patio naturally lighted distributes the access to each office. A storage place in metal gratings and the furniture designed in-house ensures the originality and audacity of the project.

The partitioning is provided by glass walls and concrete walls coated with acoustic felt.

Typology

Offices (include mixed use)

Status

Built

Conception

2014

Delivery

2016

Client

ANTHE, business and partner

LUC Spits
ARCHITECTURE

Rue de Mons 206
4600 Visé

Tél : +32(0) 4 376 69 59
Fax : +32(0) 4 376 69 22

laurent.bernard@lucspits.be
<http://www.lucspits.be>

OTHER PROJECTS :

Reality
- 2010
- Pays de Herve

25 MCT
- 2009 2009
- Dalhem

Floating metal
- 2000 2000
- Warsage

Space
- 2008 2008
- Aubin



ANTHE - Office
Â© Luc Spits



ANTHE - Office
Â© Luc Spits



ANTHE - Office
Â© Luc Spits

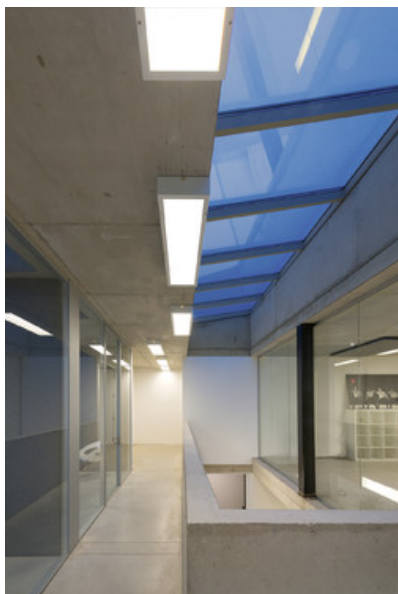

ANTHE - Office
Â© Luc Spits



ANTHE - Office
Â© Luc Spits