

## Project

# FOLKLORE MUSEUM

## Architects

V.O.

rue creuse 42  
1030 Brussels

## Address

Rue des Brasseurs, 7700 Mouscron

Tél : +32 486 22 93 37  
Fax : +32 2 248 57 05

## Programme

1. Renovation and extension of the Museum including:
  - Lobby (cloakrooms, toilets, shop)
  - Permanent and temporary exhibition halls
  - Documentation Centre with reading room and archives
  - Office spaces
  - Multipurpose room (meetings, events)
  - Space for storage of animation equipment
  - Technical rooms, boiler
  - Development of reserves
2. Management of the garden
3. Management around the Museum and garden

info@m-architecture.eu  
www.m-architecture.eu

## OTHER PROJECTS :

Bea  
- 2012-2013  
- Bruxelles

Cultural Center of Andenne  
- 2009  
- Andenne

Bridal suite  
- 2011  
- Masnuy-Saint-Jean

Creuse  
- 2009  
- Bruxelles

## About

The request of the Client was the renovation and extension of existing Folklore Museum, located in the former home of the director of the school which currently houses the Academy. Our reflections have quickly led to finding that challenges and expectations of the Client could not find the answer in a simple extension. Our proposals for its demands have been developed as follows:

1. create a new museum on the edge of the garden in order to fully enjoy it and integrate it in the museum tour
2. rotate the new museum to the old museum, the street and the city by creating a new public space, a real cultural center
3. the new museum is the hinge between each different space composing the site
4. develop a fluid and uninterrupted path between the street, the square, the park, the parking and the museum. The constructed ground area (1. Reception, 2. Documentation center and offices 3. Multipurpose room) is reduced and processed to preserve transparency of spatial and visual continuity and to develop a continuous exhibition space upstairs
5. adopt a central position to ensure the new museum has visibility from different axes
6. generate functional circulations for the ground floor: one way car / parking, delivery and pedestrians
7. create a contemporary architecture playing with natural materials

## Typology

Culture

## Status

Concept proposal

## Conception

2010

## Client

Ville de Mouscron

## Total budget

2.587.500

## Per square meters

1.450

Area	1.785
Stability	MC carré
Special techniques	Concept Control sa
Scenography	Frédéric de Smedt
Landscape	Créel sprl
Others	Codefrisko



View of the entrance  
Â© V.O.

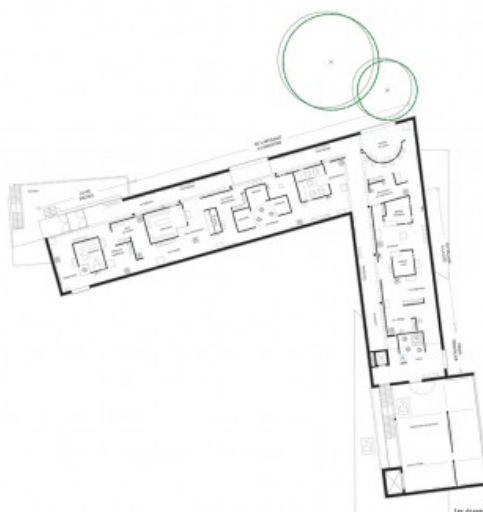
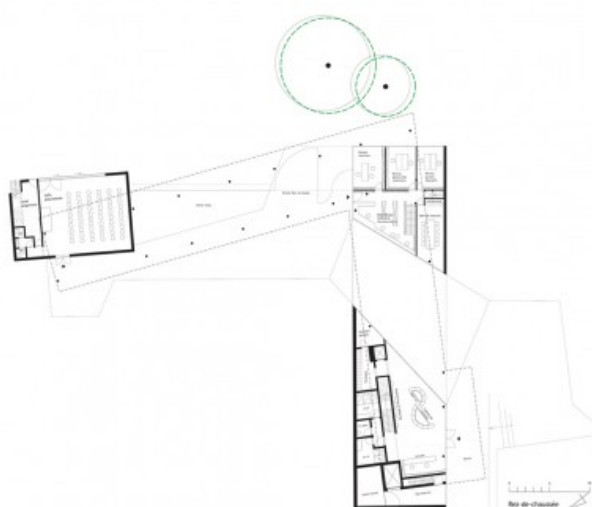

Ground floor - 1st floor  
Â© V.O.

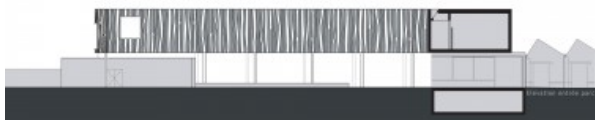
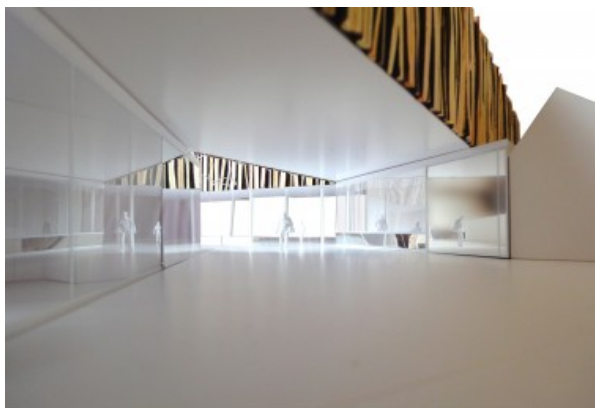

View under the building - Elevation  
Â© V.O.



View from the parking - View from the garden  
Â© V.O.



View from the street  
Â© V.O.