

Project

GENERIS - RESIDENTIAL TOWERS

Brussels / Paris

Architects

WHY ARCHITECTURE

info@whyarchitecture.eu
http://www.whyarchitecture.eu

Address

Chengdu

Programme

Urban project for nine residential towers and landscaping

About

Chengdu is located on the edge of the bamboo forests of central China. In 2010, its urban population was approximately 9 million. Like many of the city's lots, the square and completely flat plot of land is surrounded by roads, and is located amidst monotonous low- and high-rise housing units.

Generis's project ? using simple construction techniques and in line with the existing housing density ? involved creating a specific living environment within a systematic whole. Generis varied a few of the components to stimulate the creative process. The reuse of elements was secondary to the design, the spaces and the users, in contrast with structures that are built based on common aesthetics, a laundry-list of functions and simplistic technical approaches. The location of the nine towers, each between 110 and 140 metres tall, is based on natural light and avoids apartments that face each other ? a recurring problem in Chengdu. The towers' silhouettes are curved, and invite exploration of the site. Bamboo, the dominant material in the reconstructed landscape, is used for the interior facades of the patios with which each unit is fitted.

OTHER PROJECTS :

Reine Astrid - Public square
- 2009
- Visé

Ecole Hôtelière - Hotel boarding school
- 2009-...
- Namur

Waterloo - Housing and commercial space
- 2011-...
- Uccle

Jardin de Poche - Installation
- 2004 2004
- Bruxelles

Typology

Housing (include mixed use)

Status

Concept proposal

Conception

2010-2011

Area

168.000 m²



Â© WHY architecture



Â© WHY architecture

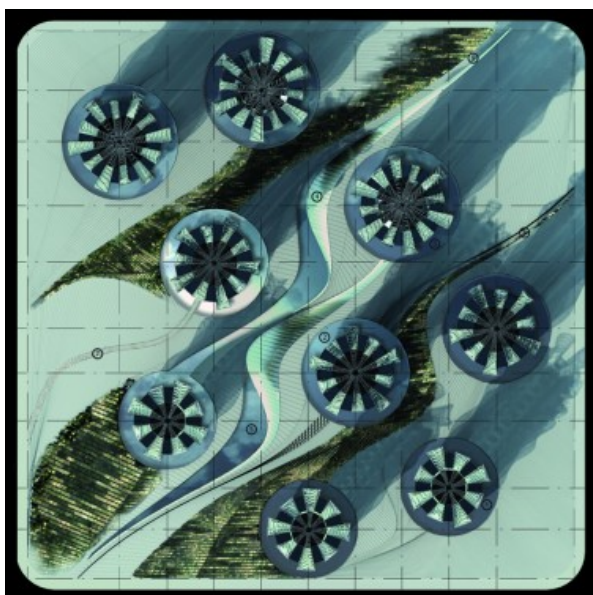

Â© WHY architecture

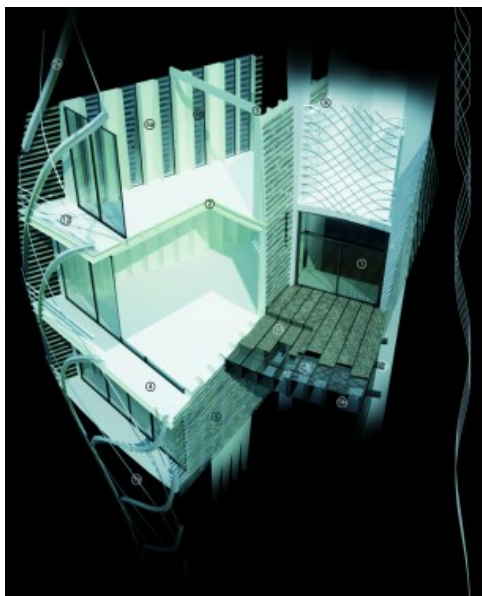

© WHY architecture



© WHY architecture