

Project

BAVIÈRE MASTERPLAN

Architects

ANORAK

rue de Flandre 121
1000 Bruxelles

Address

boulevard de la Constitution , 4000 Liège

Tél : 32 2 732 18 56
Fax : 32 2 732 18 56

Programme

Urban, landscape and architectural studies (design for 800 housing units)

info@anorak.be
www.anorak.be

About

competition 2006 / 1st prize / studies 2006-2008 / stand by

OTHER PROJECTS :

Typology

Landscape, urban areas

Belval
- 2009
- Esch-sur-Alzette

Status

Unbuilt

Conception

2005

Xhendremael
- 2006 2010
- Liège

Total budget

± 100 millions

Per square meters

1150 euros

Area

100 000

Stability

Ing. en studie bureau Peeters

Special

Bureau d'études Pierre Berger

techniques

Landscape

Michel Desvigne Paysagiste DPLG



Â© Toon Grobet

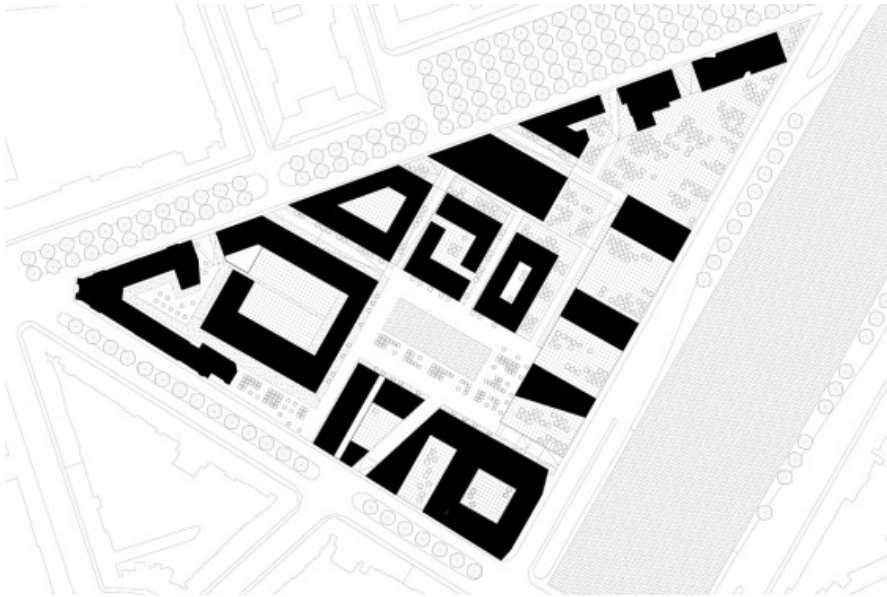

Â© ANORAK



Â© Toon Grobet

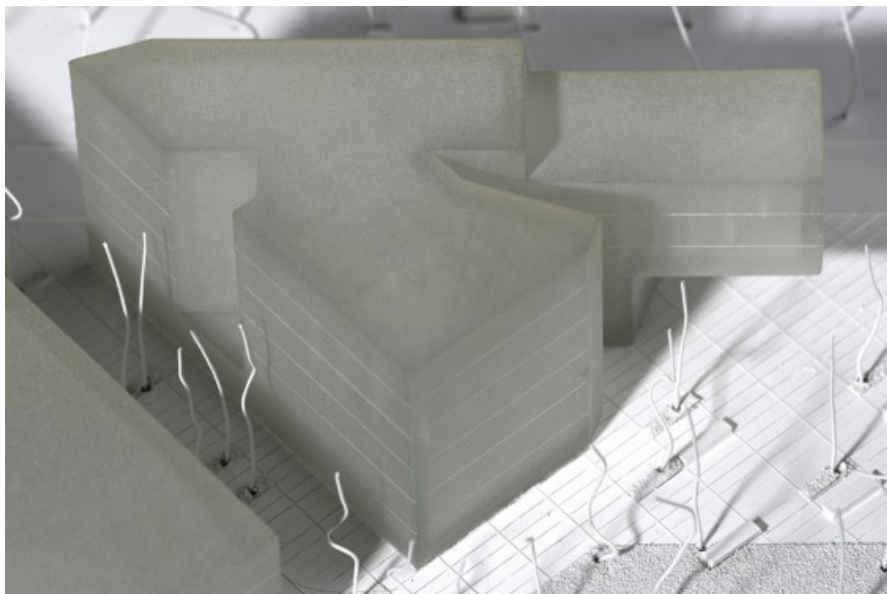

Â© Toon Grobet

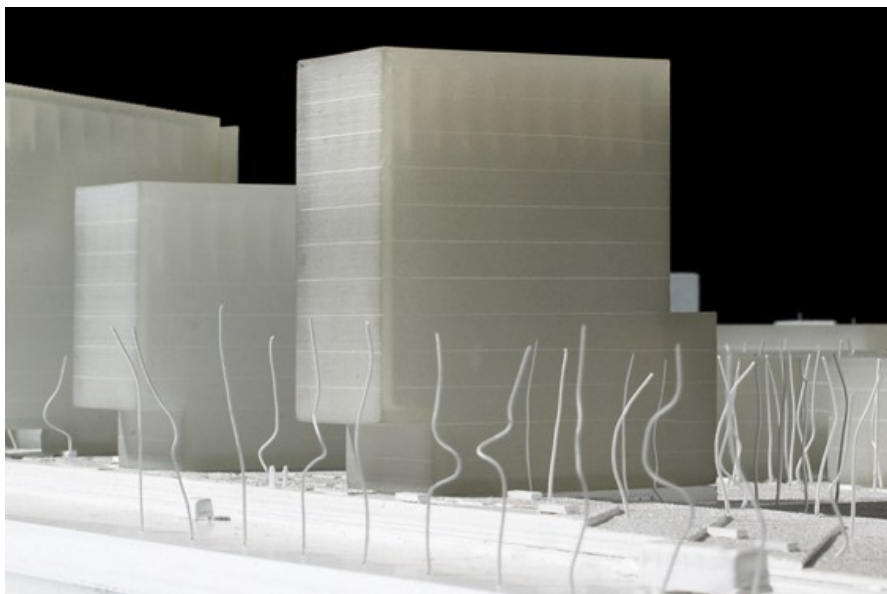

Â© Toon Grobet