

Project	CAMÉLÉON
Architects	AWAA
Address	Avenue Ariane 15, 1200 Bruxelles
Programme	Construction of a mixed use building housing private sales, a children's day care centre, a restaurant, office spaces and storage for the Caméléon clothing company.
About	<p>The desire of developers was to build an ambitious project that would become a reference of ecological design in Brussels landscape.</p> <p>Commercial buildings are generally not environmentally friendly. They usually require considerable energy input in terms of heat or cooling to provide the conditions for optimal customer comfort.</p> <p>The challenge posed by the developers was met with a consistent design of the building at all levels and with the valuable assistance of specialized consulting firms.</p> <p>Each choice in the building design was the subject of a performance analysis to maximize its environmental impact: the choice of materials with respect to their balance of life and their inertial capacity, maximizing the contribution of natural light, ventilation and cooling by free-cooling, solar protection against overheating, retention and recovery of rainwater, the production of renewable energy and the installation of educative content for visitors have achieved the "low energy" fundamentally criteria opposed to commercial practices.</p> <p>Cameleon was the first major European textile shop that does not require air conditioning and has been selected by the Government of Brussels as exemplary sustainable building.</p>
Typology	Various
Status	Built
Conception	2006
Delivery	2009
Client	Famous Clothes SA
Area	17.000
Co-author	AAVO
Stability	Boucherie NV
Special techniques	Boucherie NV
Others	Matriciel

ARE  
WE  
ALL  
ARCHITECTS?

Avenue des Ablettes, 2  
1160 Bruxelles

Tél : +32 2 770 54 22  
Fax : +32 2 770 73 86

cw@awaa.biz  
www.awaa.biz

#### OTHER PROJECTS :

Duvel Brewery  
- 2005 2008  
- Puurs

Vaux Hall  
- 2011 2012  
- Bruxelles

DOB  
- 2014 2016  
- Puurs

PO95  
- 2013 2016  
- Bruxelles



© AWAA



© AWAA

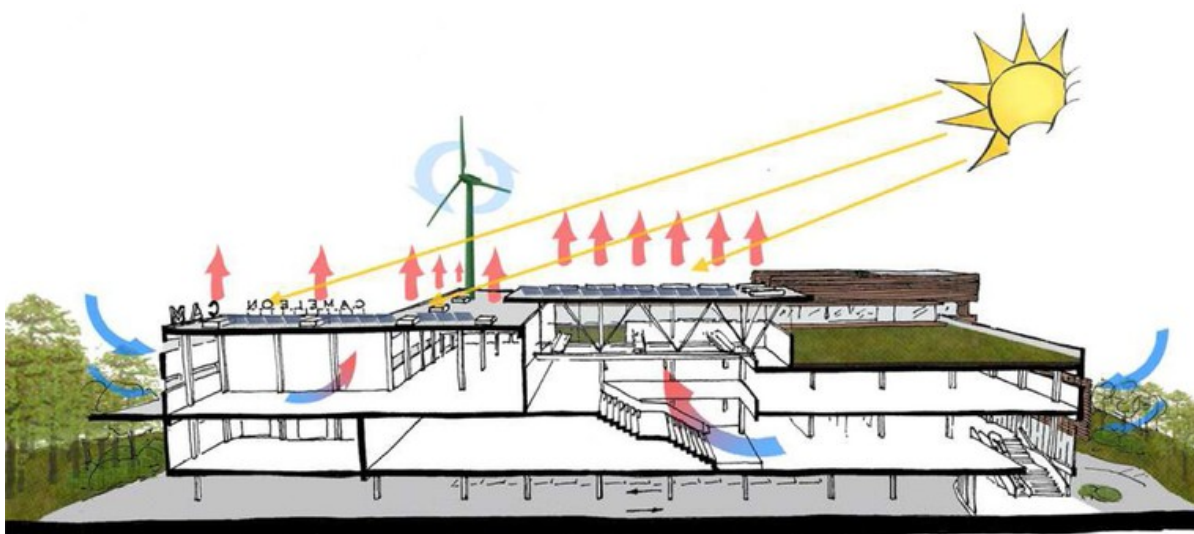

© AWAA



Â© AWAA

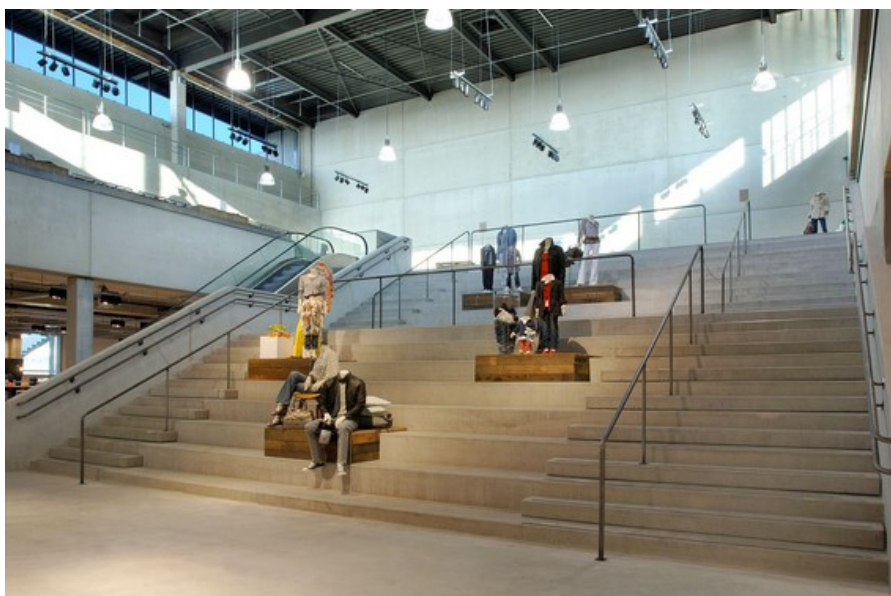

Â© AWAA