

Project

VERTEFEUILLE

Architects

ETAU ARCHITECTS

Address

Chaussée de Renaix, 196, 7500 Tournai

Programme

168-beds nursing home
64-flats assisted living residence
Selected for the day of contemporary heritage in Wallonia

About

Project in two parts, fully dedicated to the elderly, comprising a group of buildings in a park of 8 hectares at the entrance of Tournai

1) 110-beds rest and nursing home (50-beds rest home and 60-beds nursing home), completing an existing 36-beds community house.

2) 64-flats assisted living residence, receiving medical service and nursing from nursing home facilities.

This overall project, whose realisation has been spread 2004 to 2008, was an opportunity of researches and applications in the field of renewable energy.

Typology

Health

Status

Built

Conception

2004

Delivery

2013

Client

asbl Vertefeuille



45 rue des Fidèles
1180 Bruxelles

Tél : +32 (0)2 375 70 95
Fax : +32 (0)2 375 82 48

etau@etau.be
www.etau.be

OTHER PROJECTS :

HUSTIN-RH
- 2002 2006
- Charleroi

EUREKA
- 2012 2014
- Bruxelles

UNITED FOUNDATION
- 2012 2015
- Bruxelles

ST-GEORGES
- 2011 2014
- Tournai



VERTEFEUILLE - assisted living residence
Â© ETAU



VERTEFEUILLE - assisted living residence
Â© ETAU



VERTEFEUILLE - assisted living residence
Â© ETAU

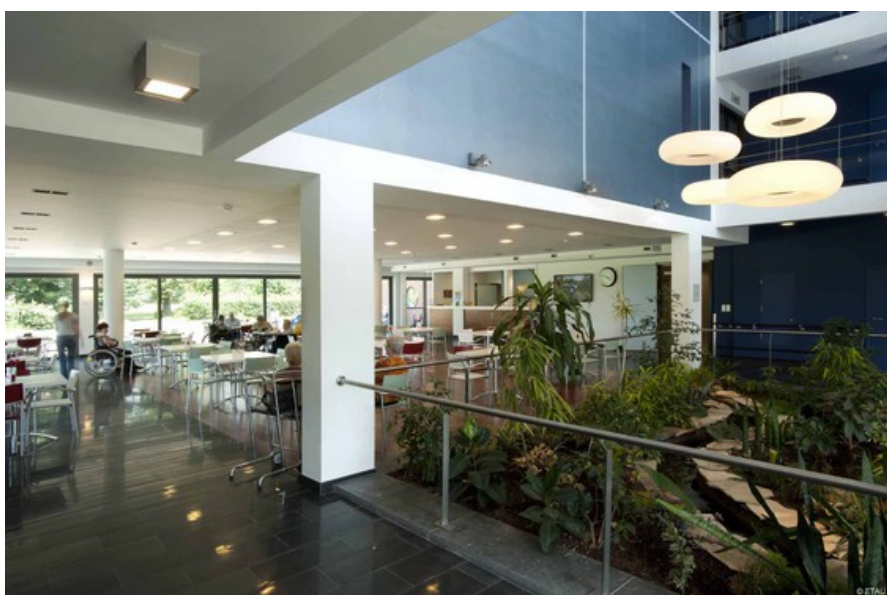

VERTEFEUILLE - nursing home
Â© ETAU



VERTEFEUILLE - nursing home
Â© ETAU