

Project

POLICE HEADQUARTERS & EXTENSION OF CHARLEROI DANSES - CHARLEROI

MDW ARCHITECTURE

Avenue de l'Armée 82a
1040 Bruxelles

Tél : +32 (0)2 428 73 76

Architects

MDW ARCHITECTURE

Address

Caserne Defeld, Boulevard Mayence 67, 6000 Charleroi

mdw@mdwarchitecture.be
www.mdw-architecture.com

Programme

Hôtel de Police / Extension de Charleroi Danses - Charleroi.

OTHER PROJECTS :

About

Beside preserving two remarkable wings of an existing cavalry building and adapting them according to low energy standards, this sustainable project includes a third vertical wing: a 75-meter new elliptical passive tower clad in blue bricks that accommodates very flexible police offices and facilities. Charleroi/Danses extension houses dance studios and residences for artists, located in small brick buildings that help preserving a human scale. A tent on the roof houses the new foyer-belvedere. All the elements of the complex are connected by a large public square directly accessible from the street and a public café invites life to enter the plaza. The unusual ensemble creates a green landmark for the city of Charleroi.

Insula

- 2004 2011
- Brussels

Savonnerie Heymans

- 2005-2008 2011
- Bruxelles

Le Lorrain

- 2006 2011
- Molenbeek-St-Jean

Typology

Offices (include mixed use)

Cross House

- 2011 2011
- Ixelles

Status

Built

Conception

2010

Delivery

2014

Client

Groupe CFE / Ville de Charleroi

Total budget

55.000.000

Area

28063

Co-author

Ateliers Jean Nouvel



Â© Filip Dujardin

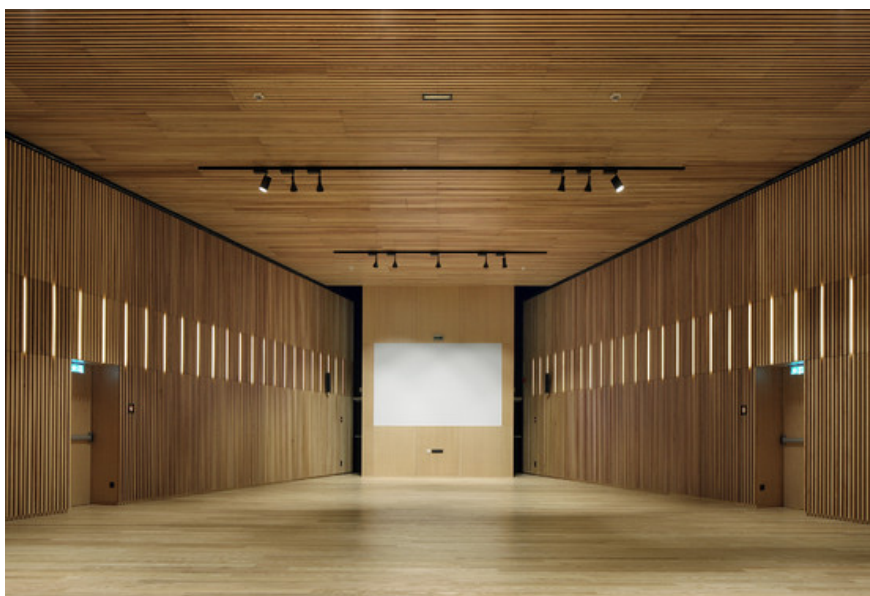

Â© Filip Dujardin



Â© Filip Dujardin

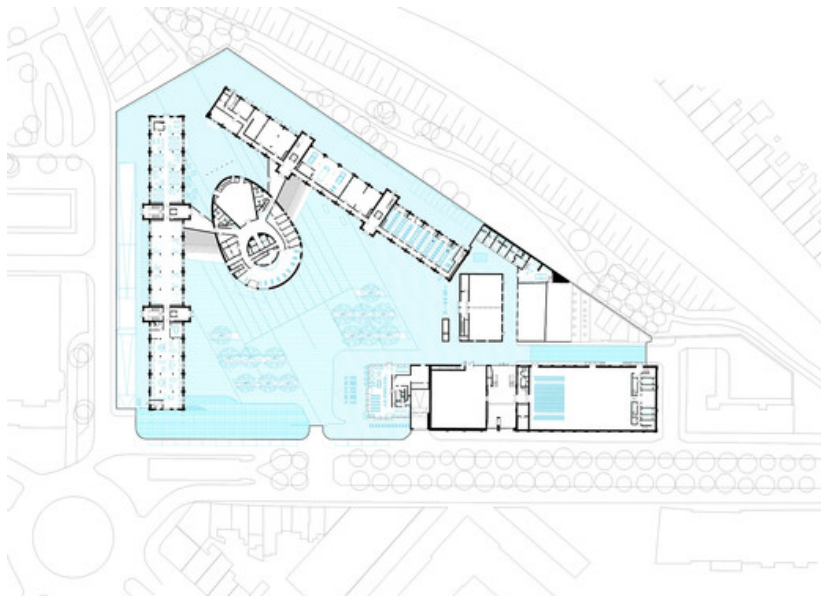

Â© MDW